



LORNE CLOSE LONDON, NW8

£1,930 PER MONTH

Stylish 1-Bedroom Apartment in the Heart of Marylebone - Moments from LBS

Located in one of London's most prestigious postcodes, this bright and well-presented one-bedroom apartment offers the perfect blend of city convenience and neighbourhood charm. Set in the heart of Marylebone, just a minute's walk from the renowned London Business School, the property is ideal for professionals or students.

Enjoy direct views over Marylebone Station, while still benefiting from a peaceful and secure setting. The apartment is superbly connected, with Baker Street Station just around the corner and Oxford Street only a short stroll away- entertainment at your doorstep.

The property has since been painted white- no longer red.

PMP | INTERNATIONAL

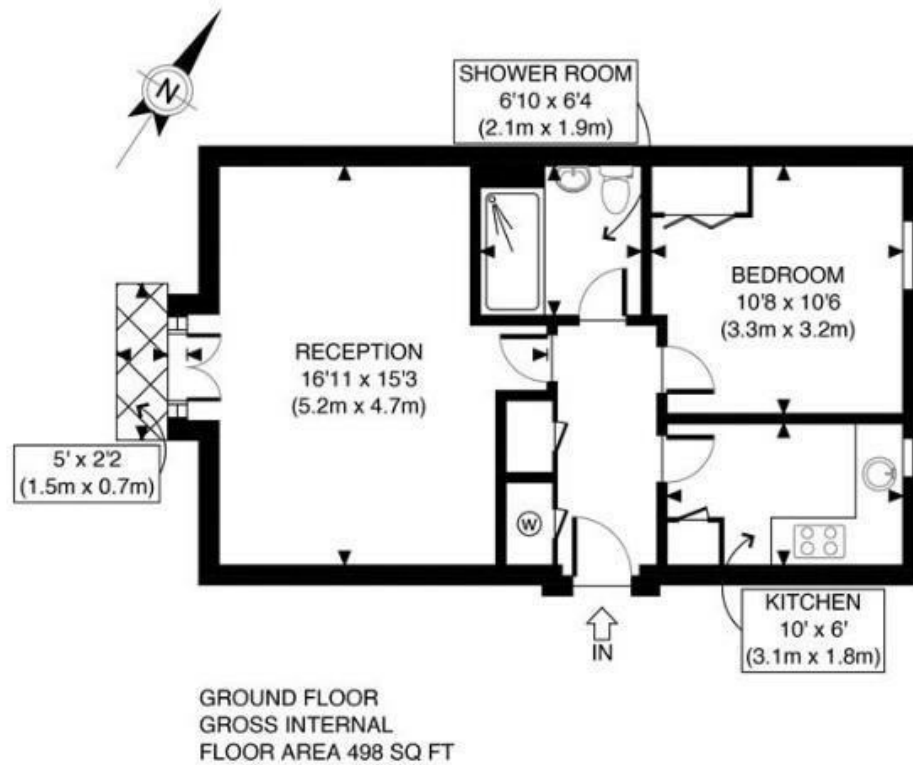

Energy Efficiency Rating		
	Current	Potential
Very energy efficient - lower running costs		
(92 plus) A		
(81-91) B		
(69-80) C		
(55-68) D	71	71
(39-54) E		
(21-38) F		
(1-20) G		
Not energy efficient - higher running costs		
England & Wales	EU Directive 2002/91/EC	

Agents Note: Whilst every care has been taken to prepare these particulars, they are for guidance purposes only. All measurements are approximate and are for general guidance purposes only and whilst every care has been taken to ensure their accuracy, they should not be relied upon and potential buyers/tenants are advised to recheck the measurements

London
PMP International
94 Belsize Lane
Belsize Park
London
NW3 5BE

020 7701 2878
info@pmpi.co.uk
www.pmpi.co.uk

PMP | INTERNATIONAL